

INSTALLATION INSTRUCTIONS

type: TITAN L4,L5, DELIA L4,L5

osmont

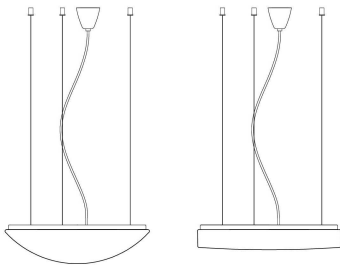

The luminaire can be used only as ceiling.

1. cut off the supply of electrical energy towards the light
2. marking of installation points on the ceiling (more ways):
 - a. use a laser plumb (alternatively a common one). Transmit the string pieces position from the luminaire (on the floor) to the ceiling
 - b. unscrew the string pieces out of the installation bases. Put the luminaire on the ceiling and mark points in the slots where the string pieces were. Screw the string pieces back tightly.
 - c. measure out and mark points on the ceiling according to the enclosed layout with measurements
 - d. put little amount of some fat, a dense paint, a chalk etc. (according to ceiling material) onto the string pieces top and press the whole set on the ceiling. There stays marked points on the ceiling. Clean the string pieces.
3. prepare the proper type of hitch in given points (dowels) according to disposition and material of the ceiling.
4. unscrew the bottom part of the ceiling hitch with string, mount the upper part to the ceiling and then screw the bottom part with string back to the upper one.



5. alongside of the feeding cable, bore a slot in the ceiling to grip the ceiling hook. Insert the dowel and screw the hook in.
6. unscrew the plastic nut of the ceiling capping strip and hitch the cable with capping strip up the ceiling hook.
7. choose the proper string and thread it through the junction (junctions) of the transparent cable and string.

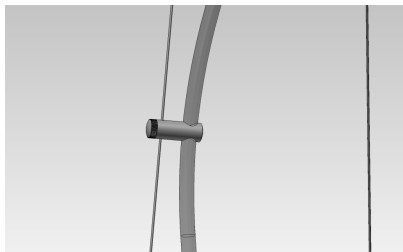

8. loosen the nuts of all string pieces

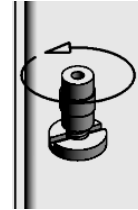

9. take the luminaire fixture and thread strings through all string pieces
10. set it in level position using the builder's level
11. after setting the right position tighten the nuts of all string pieces
12. thread the transparent cable through the grommet in the fixture. Set the cable into an aesthetically appropriate shape (with the aid of string junctions and the cable).
13. connect conductors into the terminal strip in the luminaire
14. insert the source of light (see to the label on the luminaire)
15. put the light shield onto the fixture

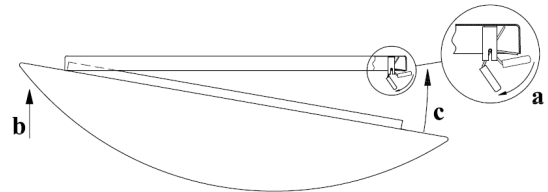

16. connect the feeding cables into the terminal strip at ceiling, draw the capping strip over it, tighten the screw to the coil tube and tighten the plastic capping strip

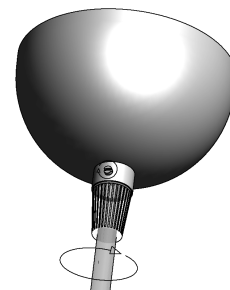

17. switch the power supply on

Electrical installation and safety :

Generally it is necessary to follow the EU regulations. At any revisions or service activity it is necessary to disconnect lighting fitting from the electrical network. Only qualified and experienced personnel must undertake this work.